

"Reaching Beyond Ourselves"



Stewardship Campaign



Reaching Beyond Ourselves

Dear Church Family,

For more than four decades, Oologah Assembly of God has worked tirelessly to extend the impact of God's Kingdom. Not only have we sent missionaries around the globe, we also have expanded our facilities to house our many activities. By working together under the leadership of founding Pastor Bob Rhoads, the sanctuary was completed in 1965. In the early 1970's the fellowship hall was added. Then in 1994 under the leadership of Pastor James Bell, the family life center was completed and the existing fellowship area was converted into a new children's auditorium. Most recently, we purchased 22 acres to relocate for future growth. Now we are beginning yet another exciting chapter in the development of our church.

Over the course of the next few weeks, we will be joining together in faith and in prayer in an effort to determine all that God has in store for us. We are beginning a stewardship campaign to raise faith for our vision and define the future of our church. Because this undertaking is so vast, we are calling the campaign, "Reaching Beyond Ourselves."

It is my sincere prayer that this campaign will help us understand what God has planned for us and the path He intends for us to follow.

As I observed the hand of God during our Possess the Land campaign, I was greatly encouraged to see God moving among us providing a renewed energy and focus. Now, as a congregation, we have the opportunity to develop a completely new facility to expand the ministry of our church. Once again, I anticipate God doing great things as we commit ourselves to His purpose.

Over the next several weeks we will have an opportunity to individually define God's purpose regarding our participation in the campaign. During this time I hope to share with you how our long history of reaching beyond ourselves has set the stage to propel us into an even more exciting future. My desire is that every step of this journey would deepen our faith. Out of that greater awareness of who we are in Christ, I am praying that we will seek God's direction in what He would have us do.

Tammy and I are asking God to guide us just as we hope you will do. And we are excited to do so, because we believe that God is at work here in Oologah. We ask that you join us, not out of guilt or pressure, but out of a profound sense of thanksgiving for all that God has blessed us with and a keen sense of His purpose for such a time as this!

A generous man will prosper; he who refreshes others will himself be refreshed. Proverbs 11:25



Pastor Kent and Tammy Jensen

Building Our Future

How often in your life do you have a chance to be part of something big? How often do you get a chance to play a pivotal role in something special that will impact hundreds or even thousands of lives in our community for years to come? This is your chance! Don't let it get by you. Pray for guidance and then listen to what God says personally to you. We believe that God has grand plans for Oologah Assembly of God and that He intends for us to make them a reality. He has brought you and this church to this place for a purpose. Let's join hands and do His work!

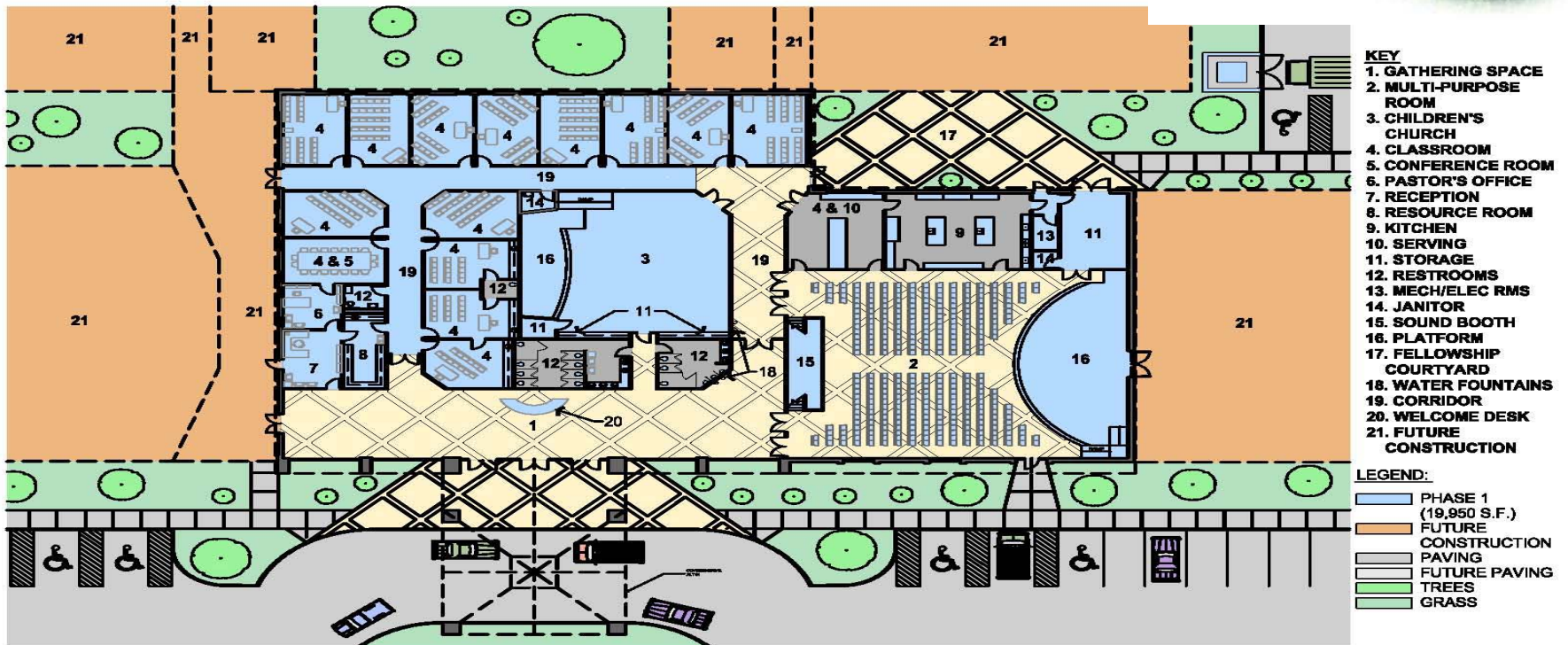

FLOOR PLAN
 EXAMINE NORTH
 TITLE NORTH

OOLOGAH ASSEMBLY OF GOD MASTER PLAN FOR NEW FACILITY OOLOGAH, OKLAHOMA



REACHING BEYOND OURSELVES

Our Purpose

There are three fundamental beliefs at the heart of "Reaching Beyond Ourselves": First, God wants His kingdom to grow and prosper; Second, the Church is God's chosen agency to bring about kingdom growth; and, Finally, a church that purposefully reaches beyond will fulfill its God-given mission and ministry and experience the favor of God!

Just as the community we serve is changing and growing, we must also adapt our strategies and expand our capabilities. This lifestyle stewardship campaign is one of the primary tools that we are using to allow Biblical principles to transform us and help us to flourish.

The concept of lifestyle stewardship begins with the belief that everything here on Earth and everything we have is provided by God. We are simply stewards, or managers, of all that is His. Therefore, we must put aside the notion that what we have belongs to us, to do with as we see fit. We must adopt a different mindset, asking ourselves, "Since all I have is really God's, what would He have me do with it?" Reaching Beyond Ourselves will help us work through this process. As our hearts and minds are transformed, we will see changes in our lives, our finances, our sense of fulfillment and much more.

This campaign is designed to help us stretch our faith and produce results in two key areas. The first area involves our relationship to God. When we exercise our faith we will experience spiritual renewal. As we pray and earnestly seek God for His guidance we can expect a renewed sense of His presence. In addition to spiritual renewal, the campaign will allow each of us to give toward the initial development of our new facility.

This giving will be above any regular giving that we do. It should be meaningful and generous, but it should also be voluntary. We will not come to your door and ask for any predetermined amount. We simply ask that you pray consistently and humbly for guidance so that you can feel confident that you personally understand God's direction for you.



Oologah Assembly of God

Why Now?

Behold, I say to you, lift up your eyes and look at the fields, for they are already white for harvest! John 4:35

The simple answer to 'why now?' is that we are continuing the outreach emphasis that has always distinguished the values of Oologah Assembly of God.

The answer gets more complicated as we factor in the huge number of unchurched families that are moving to our community and surrounding areas. We must also consider how cultural changes affect our approach to ministry. Many in our culture have little or no knowledge of God or the Bible. Others consider church to be irrelevant. This means we must develop facilities that will allow us to provide ministry that connects with

our culture while maintaining the integrity of the gospel.

After examining several models, our building committee settled on a phased approach for expansion.

The first phase will provide us with a multi-purpose space that can be used for worship and fellowship. This phase also includes space for Christian education and limited office space. Future phases include space for youth and children's ministry and a new sanctuary.

We recognize that this undertaking is "Beyond Ourselves". But, we also believe that just as our history has been a testament to God's faithfulness, He intends to continue

using us to ensure that His glory is proclaimed to following generations. The key issue behind this stewardship campaign is not property. It's about people. It's about expanding the kingdom of God as we expand our faith. It's about our willingness to trust God to work through us to fulfill the vision as we reach out to people with the life-changing message of Jesus. The amazing thing is, when we step out in faith God responds in miraculous ways!

Now is the time for us to rise up and reach our community. Now is the time to rise up and stretch our faith. Now is the time to rise up and commit ourselves to the vision God has given.

Questions & Answers

Q. When will construction begin?

A. We plan to begin construction as soon as we have the finances. This will depend, in part, on the commitments that are made throughout the campaign. We want to avoid encumbering the church with a large indebtedness. If we all work together and give generously it's possible that construction could begin later this year!

Q. How much will the construction cost?

A. Construction costs are conservatively estimated at \$100 per square foot. This calculates to nearly (2) two million dollars. Since building costs are continually on the rise, the sooner we begin the more we can expect to save.

Q. Why doesn't the first phase of our building include the sanctuary?

A. The building committee explored several options for construction and concluded that the multipurpose space would be more suitable for the first phase. This decision was based on budget concerns and the present needs of our congregation. The multipurpose building will be used for worship, fellowship, church banquets, and other gatherings.

Once the commitment is clear, you do what you can, not what you can't. The heart regulates the hands. This isn't so others can take it easy while you sweat it out. No, you're shoulder to shoulder with them all the way, your surplus matching their deficit, their surplus matching your deficit. In the end you come out even. 2 Corinthians 8:11-15 The Message Bible

Q. How long will I have to fulfill my commitment to "Reaching Beyond Ourselves?"

A. The "Reaching Beyond Ourselves" campaign involves a three-year commitment. You are encouraged to give weekly, monthly, quarterly, or annually as God enables.

Q. What happens if I need to change my commitment?

A. We are asking everyone for a three-year commitment and you can change this at any time during the course of the three-year period.

Q. Will I be asked for a public commitment?

A. Your name will never be mentioned in conjunction with your commitment. The amount you decide to give will be kept entirely confidential.

Q. When does this commitment begin?

A. The commitments will be received at the campaign banquet on Sunday evening February 17th, 2008. There will be a special offering on Sunday morning February 24th. We encourage everyone to make a ten percent offering of their commitment total at that time. This will mark the beginning of the three year period. Donations can be made during any regular offering by designating it to the building fund. The campaign will conclude on February 23, 2011.

Q. *What does a 3-year commitment look like?*

A. *By planned, regular giving each month, a small gift can be turned into a significant donation. In the example below a commitment of \$25 given each month will result in a total of \$900 over 3 years. A \$50 commitment would result in \$1800 over 3 years, etc. The main issue isn't the amount you can give. The important matter is that we all do our part. Commit to sacrificial giving as God directs you and your family. (Our vision involves equal sacrifice, not equal gifts.)*

Typical Gift Schedule

Given Monthly	Given Annually	Three Year Total
\$25.00	\$300.00	\$900.00
\$50.00	\$600.00	\$1,800.00
\$75.00	\$900.00	\$2,700.00
\$100.00	\$1,200.00	\$3,600.00
\$200.00	\$2,400.00	\$7,200.00
\$300.00	\$3,600.00	\$10,800.00
\$400.00	\$4,800.00	\$14,400.00
\$500.00	\$6,000.00	\$18,000.00
\$600.00	\$7,200.00	\$21,600.00
\$700.00	\$8,400.00	\$25,200.00
\$800.00	\$9,600.00	\$28,800.00
\$900.00	\$10,800.00	\$32,400.00
\$1,000.00	\$12,000.00	\$36,000.00
\$2,000.00	\$24,000.00	\$72,000.00
\$3,000.00	\$36,000.00	\$108,000.00
\$4,000.00	\$48,000.00	\$144,000.00
\$5,000.00	\$60,000.00	\$180,000.00

Q. *What else can I do to help?*

A. *Along with your gifts, we want you to be prayerful about the building project. Your prayers for changed lives through the ministries of our church and throughout the community and this world are key. Pray for the positive impact that we will make and the legacy that we will leave for our children and future generations. Pray for sacrificial giving and increased faith. Pray that those who are working on and around the project remain steadfast and diligent for the cause. Pray without ceasing.*

Reaching Beyond Ourselves

Our Roots

Let's take a brief journey back to the beginning – no, not THAT beginning, but to a small group of families who had a vision to plant a church in this community.

The roots of our church stretch back to 1962 when Bob and Maxine Rhoads felt God calling them to organize an Assembly of God church here in Oologah. After months of prayer and sharing the vision, a small group of people met together on December 13th, 1964. Their first service was held in a rented facility.

Those original 31 individuals were joined by others and the congregation steadily grew. With the help of God they purchased land and constructed facilities. The church flourished and began a history of mission support that would become the defining hallmark of the church. Through the years the ministries of our church have continued to grow. Over the past 43 years a strong emphasis on children and youth ministry has allowed our church to have a dynamic impact on our community. From its very beginning, this church has reached beyond itself in missionary work and in the community we serve.

Once again, God is calling the people of this church to embrace that pioneer spirit and follow Him on an exciting journey of spiritual growth. We are being called to give, not only of our abundance, but to give sacrificially of our time, our abilities, and our finances. God is calling us to "Reach Beyond Ourselves" and experience His wonderful presence and awesome promises. As we walk in obedience and faith, lives will be transformed and souls will be saved.

And now, just as you accepted Christ Jesus as your Lord, you must continue to follow him. Let your roots grow down into him, and let your lives be built on him. Then your faith will grow strong in the truth you were taught, and you will overflow with thankfulness. Colossians 2:6-7



God has given us a great history, but He is inviting us to an even brighter future. This means we each have a choice to make concerning our participation. That small group of 31 people took a step of faith in 1964. Now, their faith stands as an example for us. Will we commit to build our future on the foundation of our past? Will we commit to Reaching Beyond Ourselves to expand God's kingdom?

A NOTE FROM OUR CAMPAIGN DIRECTOR...

It takes more than just a building to make a church - it takes people... people who have fellowship with one another and most importantly, with God.

Through this fellowship, we are launching out in faith with the "Reaching Beyond Ourselves" spiritual journey and capital stewardship campaign. We believe that God is going to enable us to experience spiritual growth and fulfill the vision that He has given for His church.

But Jesus looked at them and said to them, "With men this is impossible, but with God all things are possible"

Matthew 19:26

The prevailing theme of our journey and capital stewardship campaign, "Reaching Beyond Ourselves," is a great challenge to us all. We are being called to reach beyond our present level of faith and deepen our ability to trust God. We are being called to reach beyond our present level of commitment and sacrifice to see our vision fulfilled. And, we are being called to reach beyond our present level of generosity. As we prayerfully seek God and do His will in this matter, we will grow spiritually as we walk in faithful obedience.

The commitments we make during this campaign will be very important to the future of our

families, our community, and the ministry of our church. Together under God's leadership and direction, we will achieve an exciting victory for our Lord, giving Him all the praise and glory!

*Together under
God's leadership
and direction,
we will achieve
an exciting
victory for our
Lord, giving
Him all the
praise and glory!*



Randy & Sue Rhoads
Campaign Directors

Reaching Beyond Ourselves

Capital stewardship campaigns rely on church members making gifts “over and above” their current level of giving. The best path to increased giving is the spiritual path, where you set your heart on things above. Spiritual priorities then take shape from financial priorities.

One way of defining this is, “Lifestyle Stewardship.” Lifestyle stewardship is a term used to describe a level of giving that affects our living. The challenge of Lifestyle Stewardship is to find ways, boldly and prayerfully, to let our giving touch our living.

King David declared, “I will not sacrifice to the Lord my God burnt offerings that cost me nothing.” —2 Samuel 24:24 NIV

David understood the gift that would touch the heart of God must first touch the heart of the giver! This is the spirit of Lifestyle Stewardship: If it is for my God, my gift must have value and meaning to me. Often, Lifestyle Giving means giving up something in one area so that you can give more of yourself in another. The three keys to effectiveness in Lifestyle Stewardship are:

Reassess lifestyle

Rearrange priorities

Reallocate resources

Many Christians have been amazed at their ability to give “over and above” to their church. The following seven steps are offered to help you in this regard.

Giving from your excess

A young man decided that two collector’s baseball cards worth over \$20,000 he had been holding for a number of years would be the most appropriate means of touching sacrifice for his family. Some families save money over a period of years for a special project. A couple had saved \$80,000 to build a lake cabin. When their church entered a capital stewardship campaign, they decided the needs of the church were greater than their need for a second home.

Giving Over & Above

Commit unexpected cash

Often, people pray for God to show them a way they can give beyond what they presently see or afford. Sometimes, the answers come unexpectedly. A couple had been praying for weeks about their commitment to the church capital campaign. Much to their surprise, they received an inheritance of several thousand dollars. They gave the entire amount to their church as part of their three-year commitment, in addition to a commitment from regular income.

Oologah Assembly of God

Sacrifice your extra time

Some family members have extra time they would be willing to use in a part-time job to be able to give more to the church. This is particularly true for families whose children are grown and away from home and for semi-retired couples. A man was in the process of retiring when his church entered a campaign. He and his wife secured new jobs and gave the first three years of their retirement income to the capital campaign.

Practice priority budgeting

Many families will choose to rearrange their priorities and give up something in their current budget in order to give more to a capital campaign. Priority budgeting may mean postponing a planned expenditure such as a new car, vacation, home remodeling or other major purchase. Many Christians giving to capital stewardship campaigns find a way to give through sacrificial commitments made in faith and coupled with priority budgeting.

Redirect present expenditures

Often, families have significant short-term expenditures for special needs. One example is the large expenditure a family incurs for a child to attend college. A family realized that their daughters would be graduating from college during the three years of the capital campaign and, as a result, they were able to increase their commitment to the second and third years of the campaign by thousands of dollars by giving what they had been spending on their daughter's tuition. Another example would be cash flow that is freed up when a loan is paid.

Increase giving with raises

Some people receive periodic increases in salary or bonuses from their employers. The temptation for many of us is to increase our lifestyle to fit the higher income. In many instances, families have decided they will commit the full amount of salary increases.

Donate appreciated assets

Many people own stocks that are worth significantly more than the original purchase price. That is good news. The bad news is that if these stocks are sold, a significant portion of the gain would be lost to taxation. Gifts of appreciated assets—typically investment securities or real estate—can be very advantageous to both the donor and to the church. By transferring ownership of the asset to the church, the donor avoids capital gains taxes on the sale of the asset. In addition, the donor receives an income tax charitable deduction for the full market value of the asset. This can be a smart decision for those interested in reducing taxes while helping advance the kingdom of God at the same time. While it is important to invest your giving to further the mission of the ministry God has laid on your heart, it is also important to consider the tax implications of making a gift to the church. Before making a commitment of this type, we advise you to consult your CPA, tax attorney, or other financial advisor.

A Final Word

Giving does not have to be in equal increments over the three year period of the campaign. You might be able to give more in the third year than the first two. As you think about your financial commitment to the campaign, think not of just your potential to give right now, but also of your potential to give in the future. It might be that you can make a three-year commitment in which 20 percent is given in the first year, 30 percent in the second year and 50 percent in the third. Finally, as you consider your financial commitment to the Lord's work, you might want to consider estate planning. Many sincere, committed Christians have not made provision for God in their wills and estate planning. Now might be a good time to do that. It might be as simple as including a provision in your will that 10 percent of the value of your estate will be donated to the church holding your letter of membership at the time of your passing. Or, it could involve a planned gift such as a charitable remainder trust. While such gifts do not provide immediate financial benefit to a capital campaign, they are marvelous gifts of faith commitment to carry on the work of the church for future generations.



OOLOGAH ASSEMBLY OF GOD MASTER PLAN FOR NEW FACILITY
OOLOGAH, OKLAHOMA



Not Equal Gifts,

But Equal Sacrifice



OOLOGAH
Assembly of God